

BSS

" Suitable for temperatures up to 300°C "



Pressure transmitter cooling elements are products that cool the body of the pressure transmitters in high temperature applications and protect them from temperature. They are available with various inlet/outlet mechanical connection options.

- Suitable for temperatures up to 300°C
- Suitable for pressures up to 400 bar
- G1/2 or G1/4 connections

TECHNICAL FEATURES

Operating Temperature	300°C max.
Housing Material	Stainless Steel 316L
Mechanical Connection	G1/4F-G1/2M, G1/4F-G1/4M, G1/2F-G1/2M, G1/2F-G1/4M
Weight	~280 gram
Max. Pressure	400 Bar

MECHANICAL DIMENSIONS (mm)

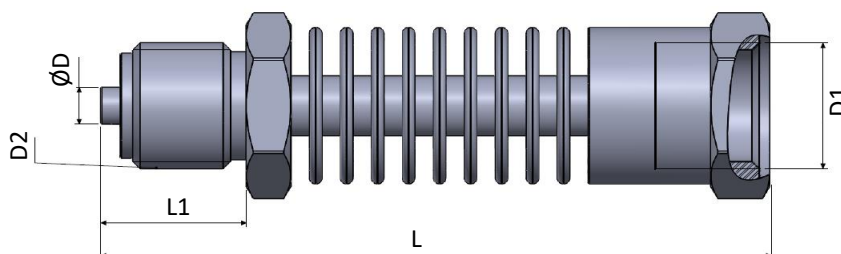
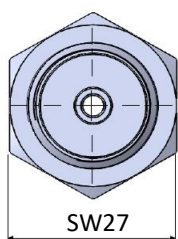

	D1 (inch)	D2 (inch)	L (mm)	L1 (mm)	ØD (mm)
G1/4F – G1/2M	G1/4	G1/2	108	23,5	6,15
G1/2F-G1/2M	G1/2	G1/2	108	23,5	6,15
G1/2F-G1/4M	G1/2	G1/4	100	15	5
G1/4F – G1/4M	G1/4	G1/4	100	15	5

CHARACTERISTIC CURVE

Temperature characteristics at 24°C ambient temperature

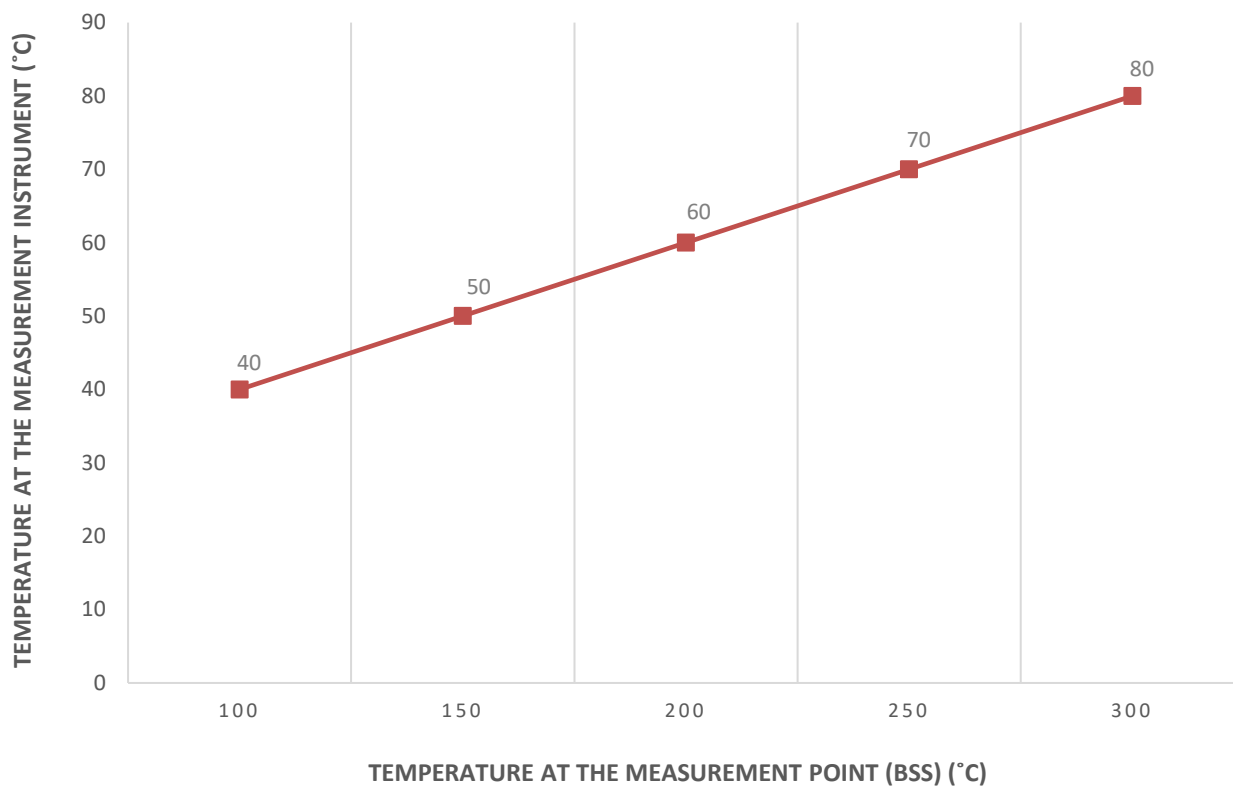

ORDER CODE

Model				Mechanical Connection	
BSS	-	26	-	G1/4F – G1/2M	
				G1/2F-G1/2M	
				G1/2F-G1/4M	
				G1/4F – G1/4M	
				Body Diameter	
				26: 26 mm	